



Intro to the Library

**OKLAHOMA
CITY**



900 N. Portland
4th Floor LRC
Oklahoma City, OK 73107

405-945-3251
okc.reference@okstate.edu

The **OSU-Oklahoma City Library** is located on the 3rd and 4th floors of the Learning Resource Center (LRC). The main Library is on the 4th floor, while a **quiet study area** is available on the 3rd floor. For your convenience an **exterior book drop** is located near the west entrance of the Learning Resource Center.

A **current OSU-Oklahoma City ID** is required to borrow materials in the library. Get your ID in Admissions on the 1st floor of the Student Center.

For more information concerning the Library and our services, please call or email us.

Library Hours

Mon.	8 a.m. - 6 p.m.
Tues.-Thurs.	8 a.m. - 5 p.m.
Fri.	9 a.m. - 5 p.m.

Check the library website for the most current information.

Interim: Mon - Thu: 8 a.m. - 5 p.m.; Fri: 9 a.m. - 5 p.m.

**The library is closed for holidays and any time campus is closed.
In the event of inclement weather, virtual services will be provided.**

osuokc.edu/library

OSU-Oklahoma City Library resources include:

- **Pete's Portal (Library Catalog)** – Use this online catalog to see what is available in the OSU-OKC Library. Locate full-text articles and eBooks within some of the online databases as well.
- **EBSCOhost and ProQuest** – Access full-text articles and eBooks in the two largest databases in the library collection.
- **ProQuest SIRS Issues Researcher / CQ Researcher / Infobase – Issues & Controversies** – Search for a wide variety of current issues and controversies. Read information from both sides of these issues. Topics include social science, education, business, nursing and health, and much more.
- **Academic Video Online (AVON)** – Create clips in this streaming video product to use in presentations and projects.
- **Visible Body: Human Anatomy Atlas** – While on campus, download this app to access information appropriate for Allied Health, anatomy classes, and more.
- **Research Guides** – Look for these guides on the library website to learn about evaluating sources, fact-checking, and more. Some are subject-specific.

For **off-campus access** to these resources and more, go to osuokc.edu/library/onlinedatabases and then “[click here for off-campus access](#)” at the top of page.

Use your O-Key user name and password.

You will be redirected to the same page and can select the database you need.

OSU-Oklahoma City Library services include:

- **GENERAL REFERENCE HELP** – Contact us by phone, email, live chat, or in person for help.
- **ZOOM** – We will meet with you by Zoom for more in-depth help.
- **LIVE CHAT SERVICE** – Use the live chat service available on the library website for help.
- **CURBSIDE SERVICE** – Let us know what you need ahead of time. Park in the designated spot in the east parking lot; call us at the number on the sign. We will deliver your printed articles or borrowed books to your car!
- **OK-SHARE CARD** - Allows you to borrow materials from participating Oklahoma colleges and universities. The cards are available to students, faculty, and staff free of charge. Please check at the Circulation Desk for more information and a list of participating colleges and universities. You must present your current OSU-OKC ID.
- **INTERLIBRARY LOAN** - To request an ILL, use WorldCat Discovery Services from the database list. Please allow a minimum of 1 week for materials to arrive.
- **RESEARCH GUIDES/HANDOUTS/PATHFINDERS** – Include helpful hints for using library resources.
- **LAPTOPS** – Laptops with access to Wi-Fi are available for checkout for use on the library's 4th floor. Laptops have a 2-hour checkout time. There is a dedicated printer for the laptops.
- **STUDY ROOMS** – Four study rooms are designated for group study. Individuals may use these rooms on a first come, first serve basis but may be asked to move if a group needs the space. Two study rooms include equipment for group collaboration. Student organizations, faculty, and staff may reserve these rooms for special meetings. Groups needing the equipment take priority.
- **LIGHTBOARD** – Record a class presentation using a clear board for writing.

OSU-Oklahoma City Library checkout policies: Renew your items through Pete's Portal (be sure to login first), by phone, by email, or through the live chat service.

Books check out for two weeks and can be renewed twice.

Media checks out for one week and can be renewed once.

Reference Materials and Periodicals are for use in the library (unless otherwise specified) and do not check out.

Reserve Materials (includes laptops) are shelved at the Circulation desk and are generally **2-hour In Library Use** only on the fourth floor of the library. Selected current textbooks will be on Reserve each semester. For information about your textbook, ask at the Circulation Desk. Please return the textbook or laptop on time so that others can borrow it.

Overdue items (60+ days) may result in a hold being placed on student records that may prevent enrollment, receiving grades and transcripts, etc. Lost items will be charged to student accounts along with a \$20 processing fee.

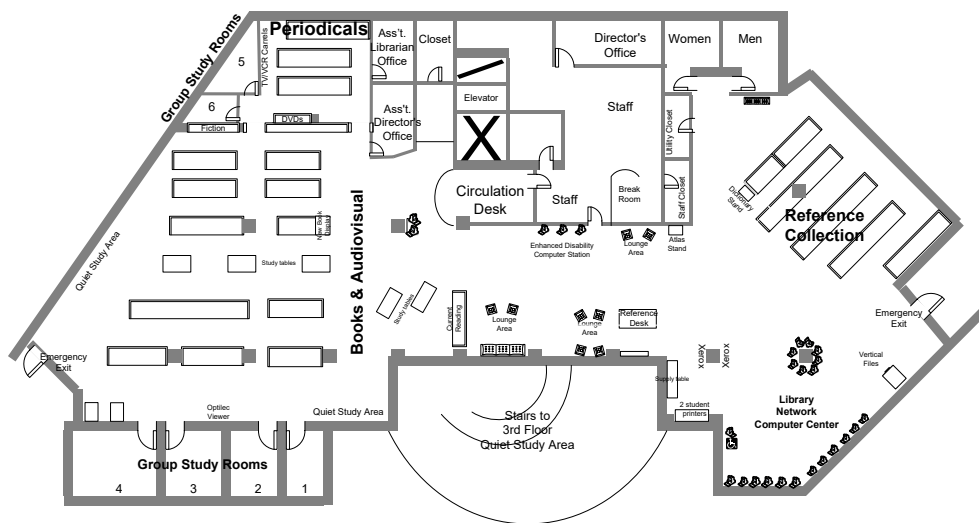

Image not to scale